

Pasquotank County, NC

Parcel ID: 892316749885

Map: P123A-2

LOT: 0

02000 RIVERSHORE RD

HARRELL, JOSEPH V

& DEBORAH W

2000 RIVERSHORE RD

ELIZABETH CITY NC 27909

Deed Book: 1181

Deed Page: 151

Date: 20130729

MB54/24

Land Value: 607000

Ag Value: 0

Bldg Value: 254200

Total Value: 861200

Taxed Acres: 4.9

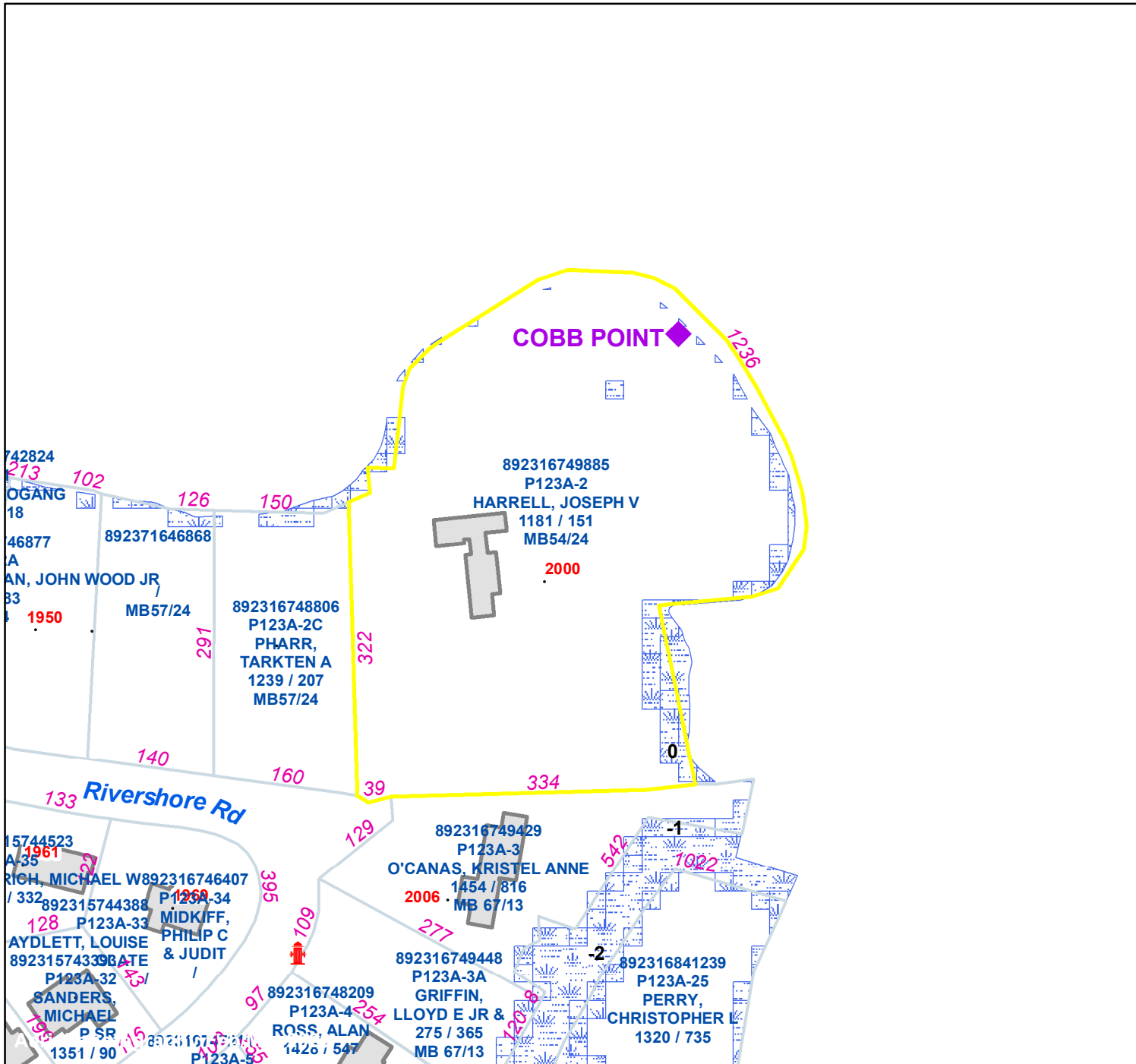

NOT A SURVEY

This map was created from historic maps, recorded deeds and surveys.
It CAN NOT be used to convey land, settle land disputes or build fences.



PASQUOTANK
COUNTY NC

Date: 3/16/2024

Property Ownership/
Lines as of January 1, 2024